

37°33'25"N
126°47'51"E

ELEV **18** m

TWR	118.05	118.1	240.9
GND	121.9	121.95	
APN	129.525	130.875	131.175

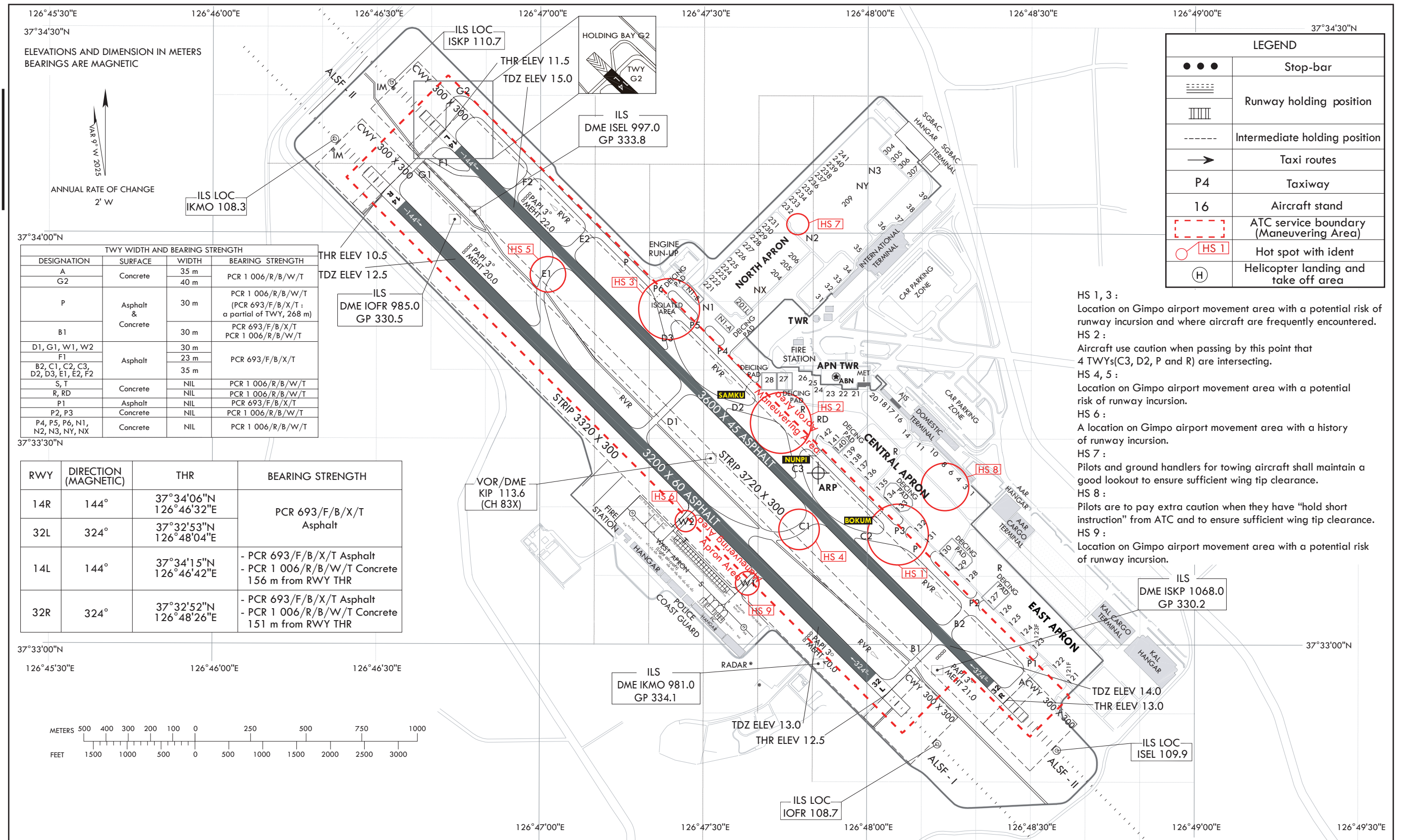

Change : Information of MAG VAR(9° W 2020 \rightarrow 9° W 2025) and annual rate of change($6'$ W \rightarrow $2'$ W).

LIGHTING AIDS RWY 14R/32L AND 14L/32R AND EXIT TWY

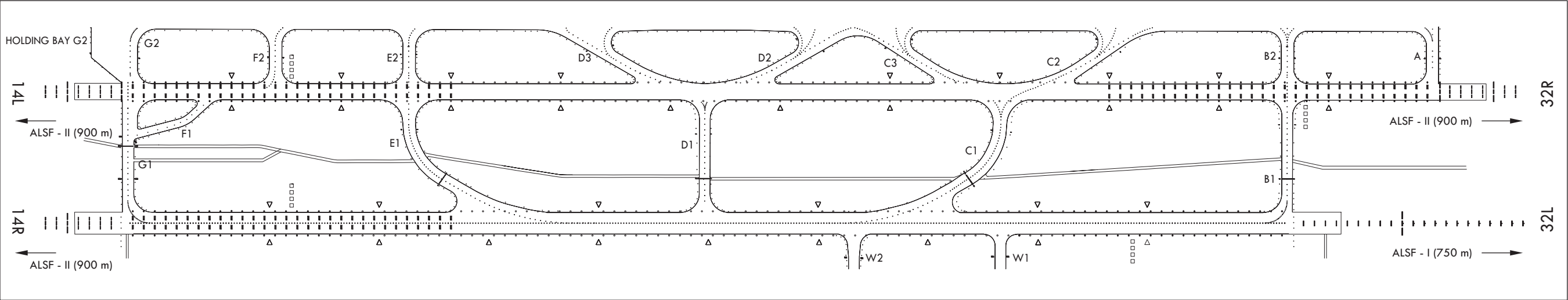

MARKING AIDS RWY 14R/32L AND 14L/32R AND EXIT TWY

